

“Foundation Gallery” Naming Initiative



香港恒生大學
THE HANG SENG UNIVERSITY
OF HONG KONG

New Academic Building Project

The Hang Seng University of Hong Kong (HSUHK) is constructing a new academic building, the **“Creative Humanities Hub”**, as part of our ongoing efforts to enhance our humanities education in response to the increase in student numbers and growing demand for additional teaching and learning facilities. The new building will be equipped with advanced multimedia facilities and digital technology to support our diversified teaching approach for students.

Introduction to Creative Humanities Hub

Located between the historic M Building and the recently developed Lee Shau Kee Complex, the **Creative Humanities Hub** symbolises the connection between “the old and the new” and is set to be a future landmark of HSUHK. As the teaching base for the School of Humanities and Social Science, the new building represents our commitment to providing students with an innovative and interactive learning environment that integrates humanities with technology, nurturing talents for Hong Kong’s art, culture, and creative industries.

The Creative Humanities Hub is a five-storey building that houses a Lecture Theatre, a **Gallery**, a Multi-Media Editing Lab, and a Multi-Purpose Digital Studio. All are equipped with cutting-edge lighting and sound systems, animation, computer, graphic, and video editing-production facilities. Discussion rooms and other teaching and research facilities will reside on the upper two floors to provide space for teachers to meet students and exchange ideas.

Introduction to Gallery

Situated on the first floor, the **Gallery** is one of the four flagship facilities in the new building, offering 150 square meters of versatile space to generate artistic and cultural experiences for visitors. With its collection and special exhibitions, the Gallery promotes public participation in the arts and cultivates appreciation for creative works. Additionally, it aims to collaborate with industry partners to enhance HSUHK’s humanistic education and facilitate scholarly projects.

Donation Support and Recognition

As a self-financing private university without government funding, HSUHK relies entirely on tuition fees and donations to support its strategic goals and campus expansion. The **“Foundation Gallery Naming Initiative”** launched by Dr Patrick Poon, Chairman of Fundraising and Donation Committee and Governor, aims to raise HK\$10 million to support the construction of the Creative Humanities Hub. Dr Poon believes that “education is the best investment” as it can have a significant impact on an individual’s life and drives progress in society and the world.

HSUHK cordially invites you / your organisation to become a Member of “HSUHK—Foundation” and support the construction of our Creative Humanities Hub. The **“Foundation Gallery”** will be named to recognise your generous support, and acknowledgement plaques engraved with your / organisation names will be placed inside the Gallery as a token of appreciation.

For more information about the naming initiative, please contact
Mr Tony Tong of our Advancement and Alumni Affairs Office (Tel: 3963-5062).



Gallery

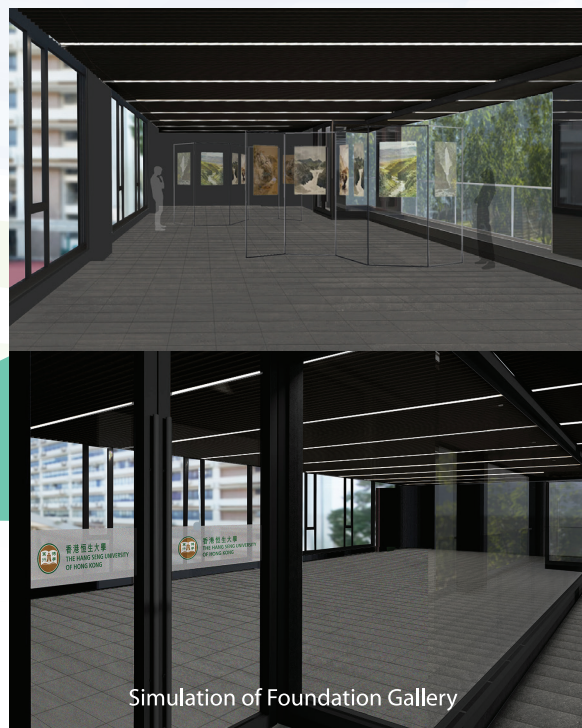

Simulation of Foundation Gallery

認捐表格 Donation Pledge Form

本人／機構* 謹此確認捐贈予香港恒生大學（恒生大學），並同意本表格中所列各項捐贈細節：包括捐贈金額、捐贈時間表、捐贈用途、表彰形式。恒生大學校董會保留接受下列捐贈之權利。I / My organisation* hereby confirm(s) the following donation to The Hang Seng University of Hong Kong (HSUHK) and my / its agreement to the donation amount, payment schedule, donation purpose, and form of recognition. The following donation is subject to acceptance by the HSUHK Board of Governors.

(請在適當位置加上「✓」號；並刪去*不適用者。Please mark with "✓" where appropriate and delete whichever inapplicable marked with a "*".)

捐贈者資料 Donor's Particulars

捐贈者類別 Type of Donor: ☐ 以個人名義捐贈 Individual ☐ 以機構名義捐贈 Organisation

稱謂 Title: ☐ 先生 Mr ☐ 太太 Mrs ☐ 女士 Ms ☐ 小姐 Miss ☐ 博士 Dr ☐ 教授 Prof. ☐ 其他 Others: _____

中文姓名
Chinese Name

英文姓名
English Name

機構名稱 Name of Organisation

中文 Chinese:

英文 English:

職銜 Position

通訊地址 Correspondence Address:

電話 Tel.:

手提 Mobile:

電郵 Email:

與恒生大學／恒管／恒商* 之聯繫

☐ 校友 Alumni

☐ 教職員 Staff

☐ 學生 Student

Affiliation with HSUHK / HSMC / HSSC*:

畢業年份 Year of Graduation:

☐ 家長 Parent

修讀課程／所屬部門* Programme Studied / Department / Unit*:

聯絡人 Contact Person (if applicable 如有)

姓名
Name

電話
Tel.

電郵
Email

捐贈資料 Donation Details

☐ HK\$20,000

☐ HK\$50,000

☐ HK\$100,000

☐ HK\$200,000

☐ HK\$1,000,000

☐ Others 其他: HK\$ _____

捐贈方式 Payment Method

劃線支票 (支票抬頭: 「香港恒生大學－基金」)

Crossed cheque (Payable to "The Hang Seng University of Hong Kong – Foundation")

請填妥本表格連同劃線支票寄交香港新界沙田小瀝源行善里香港恒生大學發展及校友事務處。

Please send the crossed cheque with this completed form to:

Advancement and Alumni Affairs Office, The Hang Seng University of Hong Kong, Hang Shin Link, Siu Lek Yuen, Shatin, NT, HK.

備註: 捐款收據抬頭將與付款人姓名相同。

Remark: The donor's name to be printed on the donation receipt should be the same as that of the payer.

鳴謝方式 Form of Acknowledgement

捐款累計總額達港幣兩萬元或以上者／機構即可成為香港恒生大學－基金會員。

Any individual / organisation that has made cumulative donations of HK\$20,000 or above to HSUHK will automatically become a Member of The Hang Seng University of Hong Kong – Foundation

☐ 本人／機構* 欲以「無名氏」代稱列於捐款者及香港恒生大學－基金名錄。

I / My organisation* wish(es) to remain anonymous in lists of donors and The Hang Seng University of Hong Kong – Foundation Members.

有關申請政府配對補助金的聲明 Declaration in Relation to Application for Government's Matching Grant

☒ 如捐贈符合「配對補助金」申請標準，本人／機構* 知悉並同意恒生大學就是項捐贈向大學教育資助委員會／教育局申請該補助，以及不反對恒生大學在需要時將有關資料提交予大學教育資助委員會／教育局。

I / My organisation* acknowledge(s) and agree(s) that if eligible, HSUHK will apply for a grant that matches this donation from the University Grants Committee / Education Bureau. I / My organisation* have (has) no objection to the disclosure of the information regarding the donation to the University Grants Committee / Education Bureau, when necessary.

☐ 本人不同意恒生大學使用上述資料向本人發佈大學資訊及活動消息。

I DO NOT wish to receive HSUHK information or publicity materials.

如欲查詢恒生大學的個人資料政策，歡迎電郵至aaaa@hsu.edu.hk。For further details about HSUHK's personal data policy, please email to aaaa@hsu.edu.hk.

簽署 Signature

日期 Date